

# FASTLIFT - MKI

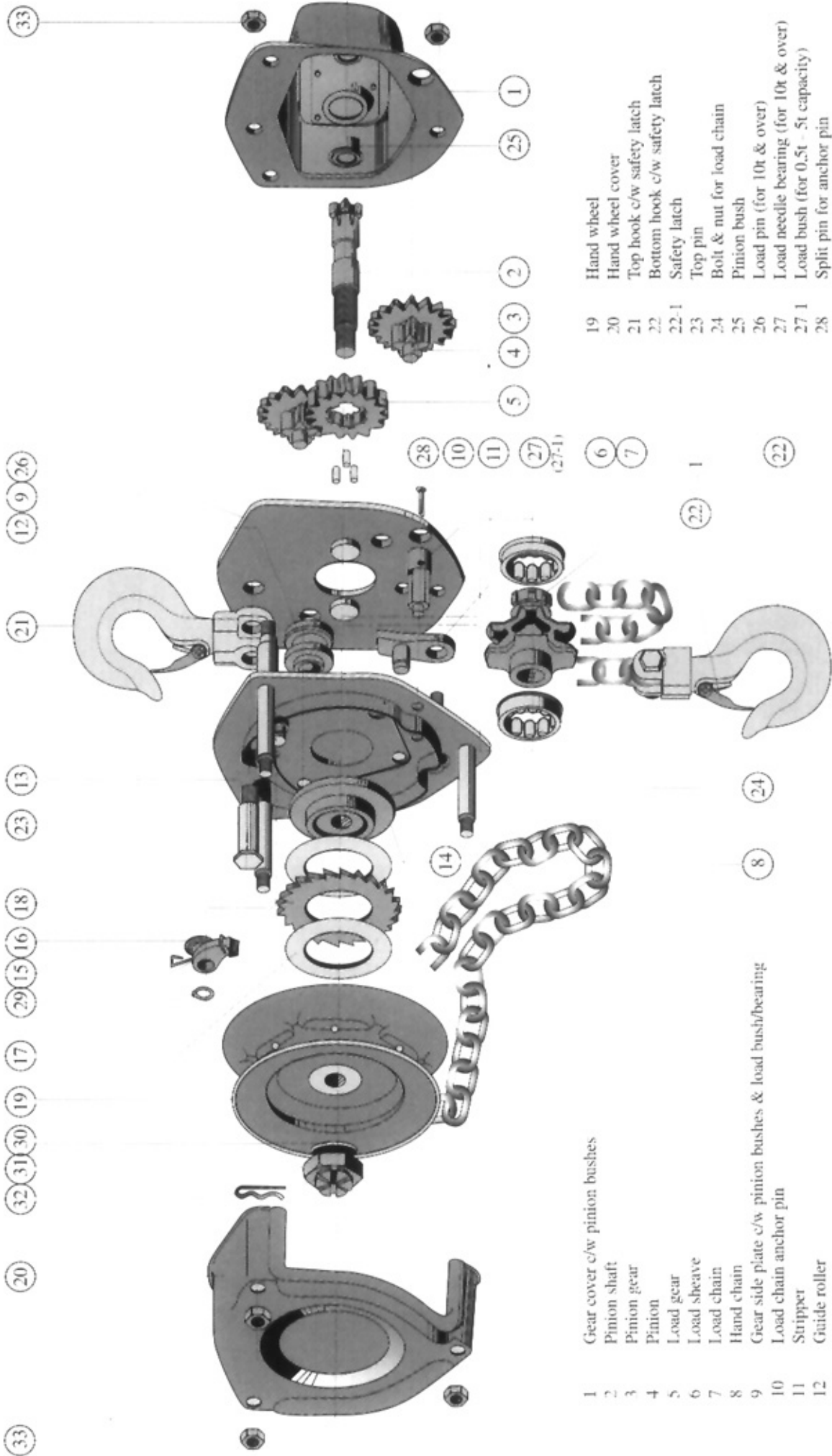

- 1 Gear cover c/w pinion bushes
- 2 Pinion shaft
- 3 Pinion gear
- 4 Pinion
- 5 Load gear
- 6 Load sheave
- 7 Load chain
- 8 Hand chain
- 9 Gear side plate c/w pinion bushes & load bush/bearing
- 10 Load chain anchor pin
- 11 Stripper
- 12 Guide roller
- 13 Wheel side plate c/w stay bolts & load bush/bearing
- 14 Disc hub
- 15 Pawl
- 16 Pawl spring
- 17 Friction plate
- 18 Ratchet

- 19 Hand wheel
- 20 Hand wheel cover
- 21 Top hook c/w safety latch
- 22 Bottom hook c/w safety latch
- 22-1 Safety latch
- 23 Top pin
- 24 Bolt & nut for load chain
- 25 Pinion bush
- 26 Load pin (for 10t & over)
- 27 Load needle bearing (for 10t & over)
- 27-1 Load bush (for 0.5t - 5t capacity)
- 28 Split pin for anchor pin
- 29 Snap ring for pawl
- 30 Hand wheel washer
- 31 Pinion shaft nut
- 32 Cotter pin
- 33 Nut
- 34 Nameplate & rivets